

2 Bedroom Purpose Built for Sale - £335,000

Friern Park, North Finchley, London, N12 9LB



KEY FEATURES:

- TWO DOUBLE BEDROOMS • GROUND FLOOR PURPOSE BUILT FLAT • LOUNGE • FITTED KITCHEN & BATHROOM • DOUBLE GLAZED • COMMUNAL GARDENS • 160 YEARS LEASE • INVESTMENT OPPORTUNITY

Description

Two double bedroom ground floor purpose built flat with a spacious lounge; fitted kitchen & bathroom, wood flooring, communal gardens, close to shops & transport links, walking distance to north Finchley high road ,Also ideal for investor current rental achived anything between £1300pcm to £1350PCM.

Ground Floor

Entrance - Communal entrance

Hallway - Wood flooring, doors to...

Lounge - 13'5 x 10'2 Double glazed window, wood flooring, radiator.

Kitchen - 10'2 x 8'3 Double glazed window, eye & base level units, single drainer sink unit, space for cooker, space for washing machine & fridge freezer, tiled, radiator.

Bathroom - Double glazed window, paneled bath with mixer taps & shower attachment, hand basin, low level WC, tiled, radiator.

Bedroom One - 12'4 x 9'5 Double glazed window, wood flooring, radiator.

Bedroom Two - 10'2 x 10'2 Double glazed window, wood flooring, radiator.

Exterior - Communal gardens.

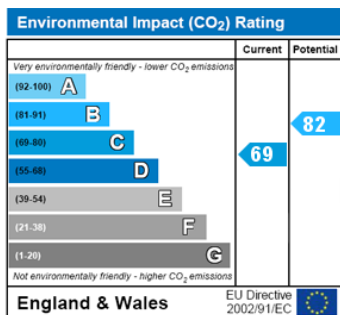
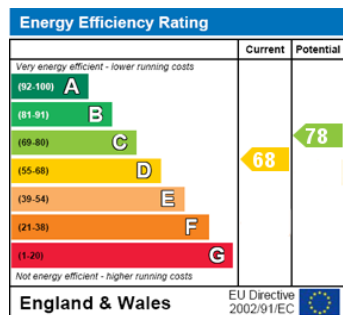

CARDEW COURT, FRIERN PARK, NORTH FINCHLEY N12 9LB

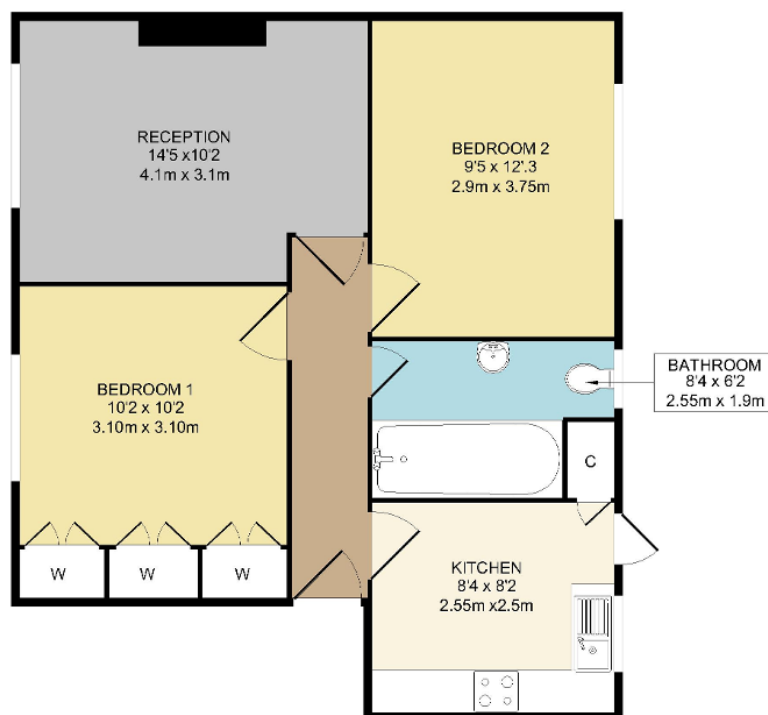

GROUND FLOOR FLAT
APPROX. FLOOR
AREA 549 SQ.FT.
(51 SQ.M.)

TOTAL APPROX. FLOOR AREA 549 SQ.FT. (51 SQ.M.)

Whilst every attempt has been made to ensure the accuracy of the floor plan contained here, measurements of doors, windows, rooms and any other items are approximate and no responsibility is taken for any error, omission, or mis-statement. This plan is for illustrative purposes only and should be used as such by any prospective purchaser. The services, systems and appliances shown have not been tested and no guarantee as to their operability or efficiency can be given.