

1 Bedroom Conversion for Sale - £289,950

High Road, Whetstone, London, N20 9HJ



KEY FEATURES:

- ONE DOUBLE BEDROOM SPACIOUS FLAT • SPACIOUS LOUNGE • MODERN FITTED KITCHEN & BATHROOM • DOUBLE GLAZED • HARDWOOD FLOORING • CLOSED TO SHOPS & TUBE • LONG LEASE & CHAIN FREE • IDEAL FOR INVESTMENT & FIRST TIME BUYERS

Description

Reedandco would like offer this superb One double Bedroom first floor period flat above shop close to restraunts, Totteridge & Whetstone Tube,with a spacious lounge with modern fitted kitchen, modern fitted bathroom, high ceilings, double glazed, hardwood flooring, gas central heating. Offered Chain Free.

Its also a investment opportunity with rent achived between £1000 to£1100 pcm.

Location

This flat is in a fantastic location of whetstone high road with a minutes walk to whetstone & Totteridge tube station and also surrounded by lavish restaurants,close to all shopping amenties

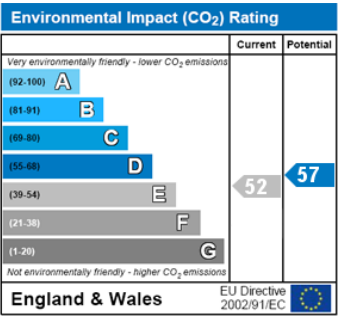
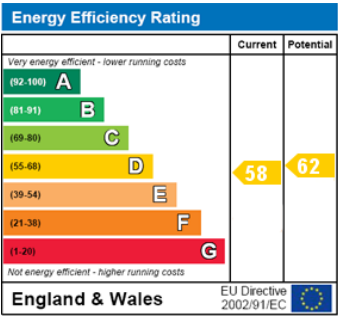

HIGH ROAD, LONDON N20 9HJ

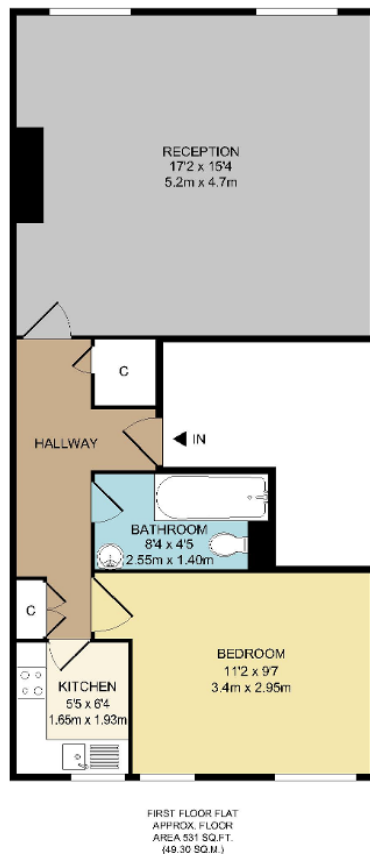

TOTAL APPROX. FLOOR AREA 531 SQ.FT. (49.30 SQ.M.)

Whilst every attempt has been made to ensure the accuracy of the floor plan contained here, measurements of doors, windows, rooms and any other items are approximate and no responsibility is taken for any error, omission, or mis-statement. This plan is for illustrative purposes only and should be used as such by any prospective purchaser. The services, systems and appliances shown have not been tested and no guarantee as to their operability or efficiency can be given.